

Adjustable hinge



- **Material**
Glass-fibre reinforced polyamide based (PA) technopolymer. Resistant to solvents, oils, greases and other chemical agents.
- **Colour**
Black, matte finish.
- **Adjusting inserts**
Technopolymer, black colour.
- **Rotation pin**
AISI 303 stainless steel.
- **Assembly**
Through holes for M6 countersunk-head screws.

Features and applications

The adjusting inserts (ELESA patent) are designed to compensate limited misalignments of doors. Vertical and horizontal adjustments are both possible by simply setting the orientation of the inserts. The knurling on the hinge body holes and on the rear of the inserts avoid any accidental offset of the coupling during the assembly of the hinge so as to offer a secure mounting. A single product code to compensate vertical, horizontal or both misalignments.

Rotation angle

Max 270°, between 0° and -90° and between 0° and 180° (0° = condition where the two interconnected surfaces are on the same plane). Do not exceed the rotation angle limit (see drawing) so as not to prejudice the hinge mechanical performance. To choose the convenient type and right number of hinges for your application, see the Guidelines (see page 792).

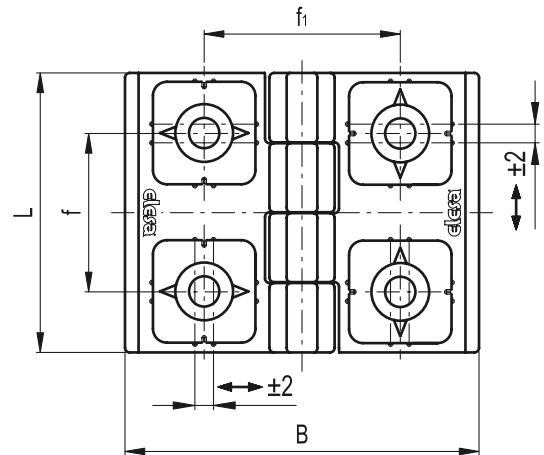
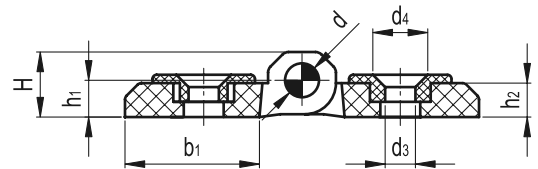
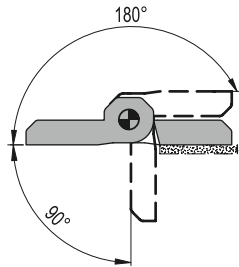

Assembly instructions

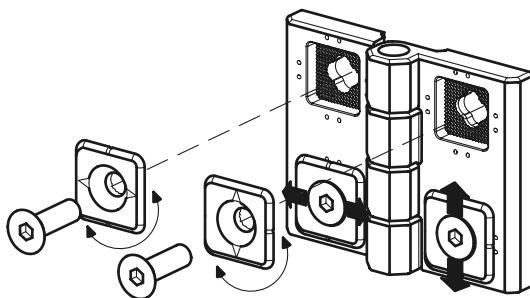

Standard Elements		Main dimensions									Mounting holes		Δ
Code	Description	B	L	f	f ₁	H	h ₁	h ₂	b ₁	d	d ₃	d ₄	g
426431	CFR.60 SH-6	75	60	34	42	16	9.5	8	29.5	8	6.5	12.5	72

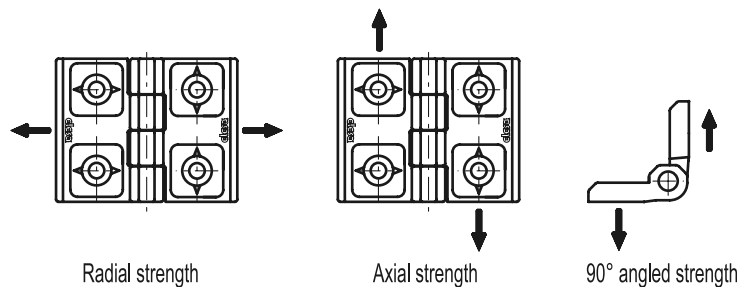

Standard Elements		RADIAL STRENGTH	AXIAL STRENGTH	90° ANGLED STRENGTH	Tightening torque [Nm]
Code	Description	Maximum working load E _r [N]	Maximum working load E _a [N]	Maximum working load E ₉₀ [N]	SH
426431	CFR.60 SH-6	2700	1800	2130	>5

