

Detent position hinges with screw-covers



Material

Acetal resin based (POM) technopolymer. Resistant to solvents, oils, greases and other chemical agents.

Colour

Black, matte finish.

Assembly

- Execution **SH**: through holes for countersunk head screws.
- Execution **CH**: through holes for cylindrical head screws.
- Execution **EH**: through holes for hexagonal head screws.

Screw-covers

Polyester based (PBT) technopolymer, black colour, matte finish, snap-in assembly.



12
834

Hinges

Characteristics

The detent device (ELESA patent) allows four detent positions:

- 0° closed
- 80° see Fig. 1
- 120° see Fig. 2
- 170° see Fig. 3.

All detent positions guarantee a positioning torque of 1.1 Nm for 10.000 cycles (thus the torque that has to be applied to free the detent device of the hinge).

Combined products

Hinge type CFQ. (see page 836) with the same design, without detent position.

Rotation angle

Max 180°, between 0° and 180°

(0° = condition where the two interconnected surfaces are on the same plane).

Do not exceed the rotation angle limit so as not to prejudice the hinge mechanical performance.

To choose the convenient type and the right number of hinges for your application, see the Guidelines (see page 792).

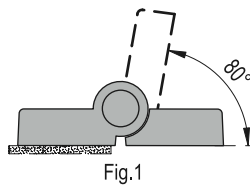

Fig.1

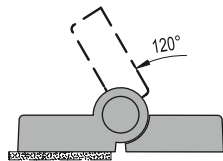

Fig.2

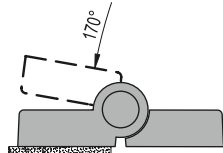
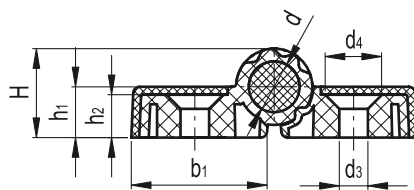
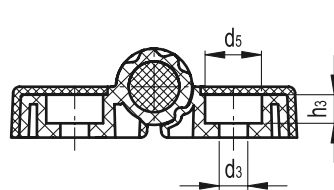

Fig.3



CFP-SH



CFP-CH

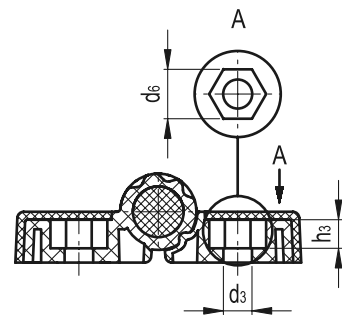

CFP-EH

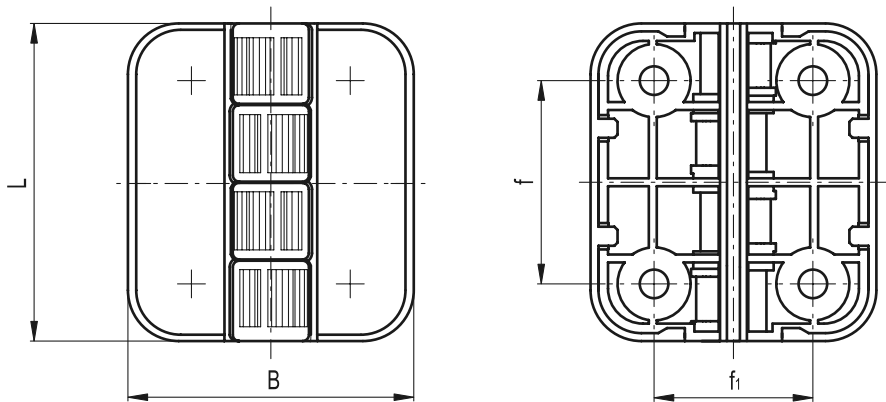
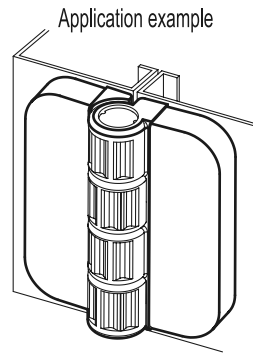

Standard Elements		Main dimensions									Fitting						Δ
Code	Description	B	L	f	f ₁	H	h ₁	h ₂	b ₁	d	d ₃	d ₄	d ₅	d ₆	h ₃	g	
426311-C9	CFP.50 SH-4-C9	45	50	32	25	14	8	7	21.5	8	4.5	8.5	-	-	-	17	
426312-C9	CFP.50 CH-4-C9	45	50	32	25	14	8	7	21.5	8	4.5	-	8.5	-	4.5	17	
426313-C9	CFP.50 EH-4-C9	45	50	32	25	14	8	7	21.5	8	4.5	-	-	7	4.5	17	

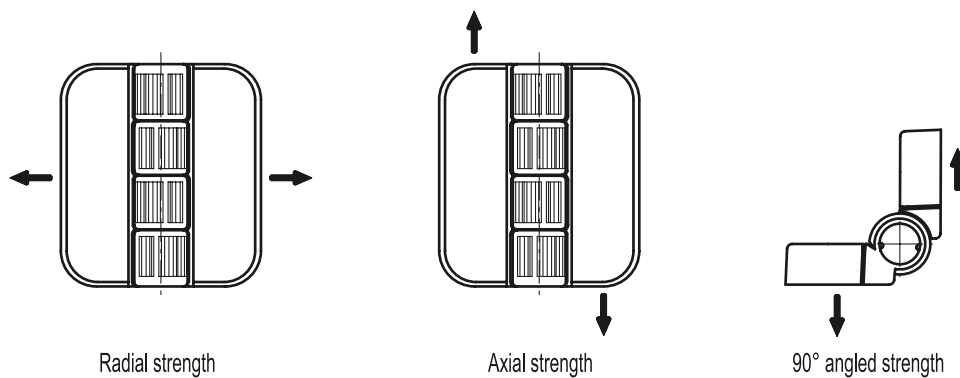

Standard Elements		RADIAL STRENGTH		AXIAL STRENGTH		90° ANGLED STRENGTH		Maximum tightening torque [Nm]
Code	Description	Maximum working load E _r [N]	Load at breakage R _r [N]	Maximum working load E _a [N]	Load at breakage R _a [N]	Maximum working load E ₉₀ [N]	Load at breakage R ₉₀ [N]	SH/CH/EH
426311-C9	CFP.50 SH-4-C9	350	1970	300	1220	290	720	2
426312-C9	CFP.50 CH-4-C9	350	1970	300	1220	290	720	1.5
426313-C9	CFP.50 EH-4-C9	350	1970	300	1220	290	720	3