

CFA+ERS

Hinges with friction brake



- **Hinge body**
High resilience polyamide based (PA) technopolymer. Resistant to solvents, oils, greases and other chemical agents.
- **Colour**
Black, matte finish.
- **Rotation pin**
Black-oxide steel.
- **Assembly**
Through holes for countersunk head screws.
- **Adjustable handle**
Glass-fibre reinforced polyamide based (PA) technopolymer. Red writing "PUSH" tampoprinted on the lever body (avoid contact with solvents, alcohol or detergents containing alcohol).
Black-oxide steel retaining screw, AISI 302 stainless steel return spring.
- **Lever colour**
Grey-black, matte finish.
- **Lever assembly**
Black-oxide steel bushing, tapped blind hole (CFA.49 and CFA.65).
Brass bushing, tapped blind hole (CFA.97).

Rotation angle

Max 220°, between 0° and -40° and between 0° and 180°
(0° = condition where the two interconnected surfaces are on the same plane).
Do not exceed the rotation angle limit (see drawing) so as not to prejudice the hinge mechanical performance.

Features and applications

CFA+ERS hinge has been developed to offer an unlimited number of door-stop positions within the rotation angle of 220°. The friction between the two hinge bodies controls the speed of opening and closing operations.

Instructions of use

The friction effect is obtained by clamping the two hinged bodies using the special adjustable handle. To operate the adjusting mechanism, push down the lever (PUSH). By releasing the lever, the spring releases the toothing, thus the handle can return to its starting position and the lever can rotate freely together with the door without obstacles for the operator manoeuvres, even in case of accidental shock. The high number of teeth within the adjustable handle guarantees rotation even in case of very limited movement of the lever arm.

To choose the convenient type and the right number of hinges for your application, see the Guidelines (see page 792).
Strength values: see the corresponding models of CFA. (see page 794).

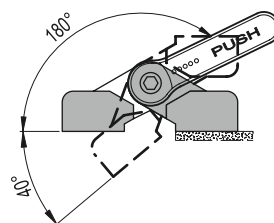
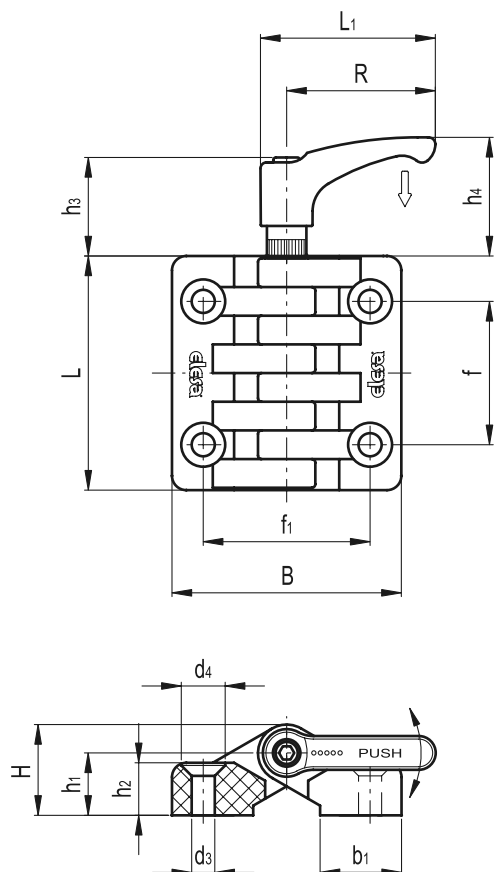

Application example

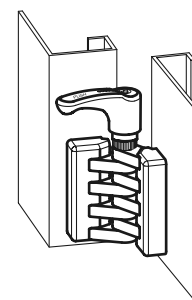

Standard Elements		Main dimensions											Fitting		△	
Code	Description	B	L	f	f ₁	H	h ₁	h ₂	b ₁	R	L ₁	h ₃	h ₄	d ₃	d ₄	g
422134	CFA.49 SH-5+ERS	48	49.5	30.5	31	19	13	11	17	44	52	29	36	5.5	10	40
422234	CFA.65 SH-6+ERS	64	65	40	40	23	15	13.5	24	44	52	29	36	6.5	11.5	75
422334	CFA.97 SH-10+ERS	97.5	96.5	59.5	62.5	35	23	20.5	35	63	73.5	37	48	10.5	20	240