

GN 505

T-Nuts

• Material

- Execution **MB**: zinc-plated steel, with increased torque.
- Execution **OB**: zinc-plated steel, without increased torque.

Features and applications

T-nuts for aluminium extrusions GN 505 can be inserted vertically into a T-slot like Rhombus nuts GN 508.1.

When tightening the clamping bolt, the nut will be forced into a crosswise position by the applied torque and firmly anchored in the T-slot.

This action is achieved by using T-nut type MB which is intentionally fitted with an overtight fit requiring a higher torque.

To remove the bolt and T-nut a 90° anticlockwise turn is sufficient to withdraw the two components with the clamped workpiece.

The clamping face of the T-nut is serrated to ensure that a possible plating coat in the T-slot is penetrated to establish a good electrical contact.



Application example

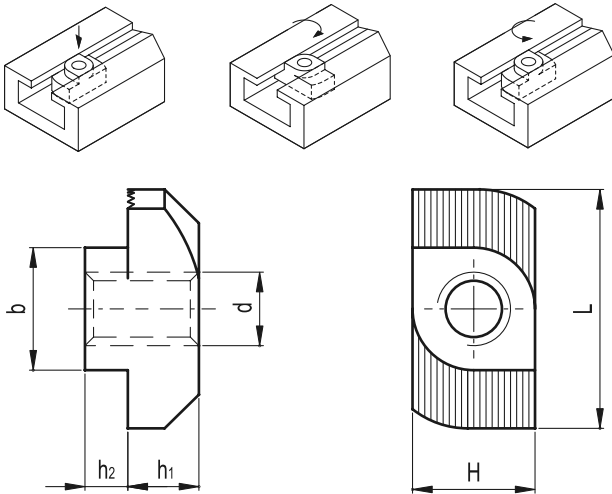

Standard Elements	Main dimensions						⚖
	^{-0.1} b-0.5	L ±0.5	^{-0.1} H-0.5	d	h1 -0.4	h2	
GN 505-8-M4-MB	8	16	8	M4	5	1.6 -0.4	7
GN 505-8-M5-MB	8	16	8	M5	5	1.6 -0.4	7
GN 505-8-M6-MB	8	16	8	M6	5	1.6 -0.4	6
GN 505-10-M4-MB	10	19	10	M4	5.8	3.5 -1	8
GN 505-10-M5-MB	10	19	10	M5	5.8	3.5 -1	7
GN 505-10-M6-MB	10	19	10	M6	5.8	3.5 -1	7
GN 505-10-M8-MB	10	19	10	M8	5.8	3.5 -1	6
GN 505-8-M4-OB	8	16	8	M4	5	1.6 -0.4	7
GN 505-8-M5-OB	8	16	8	M5	5	1.6 -0.4	7
GN 505-8-M6-OB	8	16	8	M6	5	1.6 -0.4	6
GN 505-10-M4-OB	10	19	10	M4	5.8	3.5 -1	8
GN 505-10-M5-OB	10	19	10	M5	5.8	3.5 -1	7
GN 505-10-M6-OB	10	19	10	M6	5.8	3.5 -1	7
GN 505-10-M8-OB	10	19	10	M8	5.8	3.5 -1	6

GN 507

T-Nuts

• Material

Zinc-plated steel.

Features and applications

T-nuts GN 507 have been specially designed for use on aluminium extrusion rails. They are inserted from either end of the T-slot.

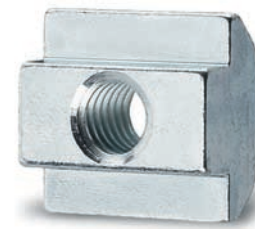

Application example

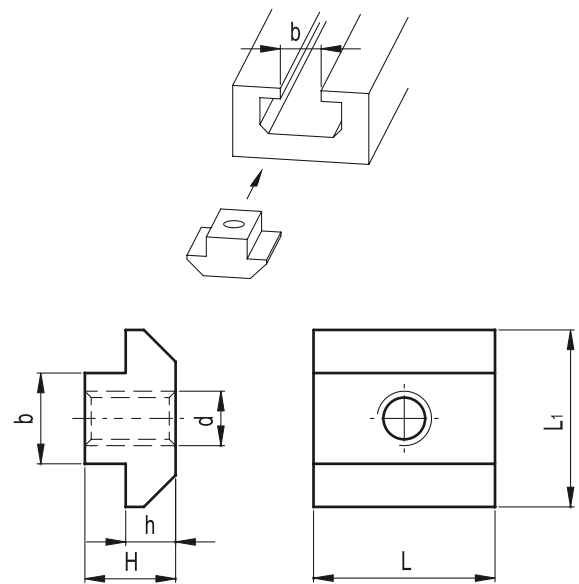

Standard Elements	Main dimensions						Width	⚖
	^{-0.1} b-0.3	L	L1	H	d	h +0.1		
GN 507-8-M4	8	16	16	6	M4	4.2	8	13
GN 507-8-M5	8	16	16	6	M5	4.2	8	12
GN 507-8-M6	8	16	16	6	M6	4.2	8	11
GN 507-8-M8	8	16	16	6	M8	4.2	8	10
GN 507-10-M4	10	20	19.5	10	M4	5.5	10	13
GN 507-10-M5	10	20	19.5	10	M5	5.5	10	12
GN 507-10-M6	10	20	19.5	10	M6	5.5	10	11
GN 507-10-M8	10	20	19.5	10	M8	5.5	10	10