

LBR.

ELESA Original design

Control levers



• Lever body

Glass-fibre reinforced polyamide based (PA) technopolymer. Resistant to solvents, oils, greases and other chemical agents.

• Colour

Black, glossy finish.

• Assembly

Black-oxide steel boss, H7 reamed hole.

• Lever arm

Matte chrome-plated steel with cylindrical handle type I.280 (see page 392) in phenolic based (PF) Duroplast, black colour, glossy finish.

• Self-adhesive front plate

Matte anodised aluminium to be fitted after the assembly of the lever.

Accessories on request

- Axial retaining washer type GN 184 (see page 631).
- Ball and spring for clicking operation to be fitted into the two holes drilled at 180° (see ball and spring MS. on page 425).

Special executions on request (For sufficient quantities)

- Different arms lengths.
- Different handles shapes.
- Front plate with words, marks, symbols, graphics, etc...

Limited manoeuvre angle assembly

A limited manoeuvre angle assembly is possible by setting on the machine frame one or two stop pins matching the rear guide slots of the lever body.



6

442

Control elements

Assembly examples

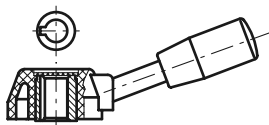

Assembly by means of a keyway

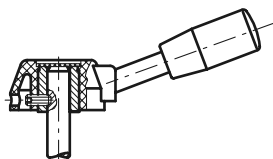

Assembly by means of a set screw

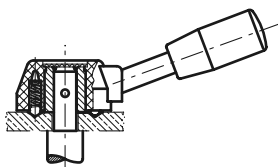

Assembly by means of ball and spring for clicking operation

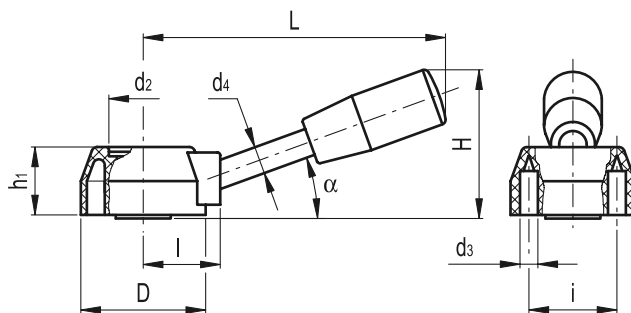
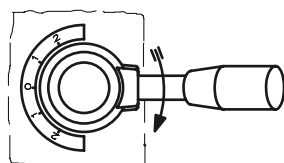

Holes for ball and spring

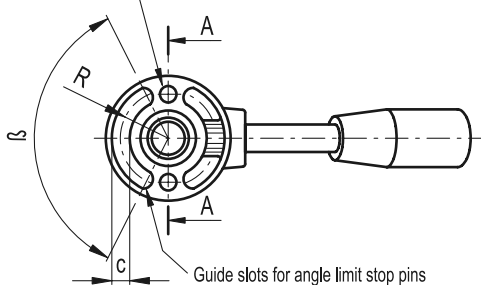

Guide slots for angle limit stop pins

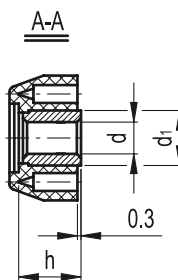

Standard Elements		Main dimensions														Mounting hole		Δ
Code	Description	D	L	H	h ₁	α	d ₁	d ₂	d ₃	d ₄	i	l	R	c	β	d H7	h	g
33101	LBR.37/85 A-8	37	81	46	20	25°	18	21	5	10	26	22	13.8	4.3	125±1°	8	17	75
33102	LBR.37/85 A-10	37	81	46	20	25°	18	21	5	10	26	22	13.8	4.3	125±1°	10	17	71
33103	LBR.37/85 A-12	37	81	46	20	25°	18	21	5	10	26	22	13.8	4.3	125±1°	12	17	66
33201	LBR.45/110 A-8	45	108	52	25	20°	22	25	6	10	32	28	17.5	7	125±1°	8	22	132
33202	LBR.45/110 A-12	45	108	52	25	20°	22	25	6	10	32	28	17.5	7	125±1°	12	22	120
33203	LBR.45/110 A-15	45	108	52	25	20°	22	25	6	10	32	28	17.5	7	125±1°	15	22	105
33301	LBR.54/130 A-10	54	127	61	30	20°	26	31	8	12	39	34	20.2	7.3	125±1°	10	27	213
33302	LBR.54/130 A-14	54	127	61	30	20°	26	31	8	12	39	34	20.2	7.3	125±1°	14	27	198
33303	LBR.54/130 A-18	54	127	61	30	20°	26	31	8	12	39	34	20.2	7.3	125±1°	18	27	175
33401	LBR.75/170 A-18	75	170	80	38	20°	30	42	10	14	55	45	26	15	105±1°	18	34	360



ELESA and GANTER models all rights reserved in accordance with the law. Always mention the source when reproducing our drawings.