

I.280

Handles

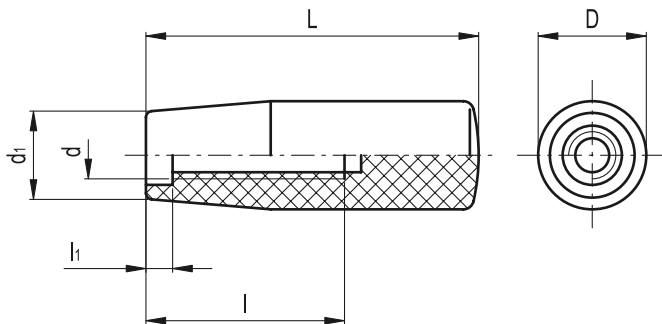

- **Material**
Phenolic based (PF) Duroplast. Resistant to solvents, oils, greases and other chemical agents.
- **Colour**
Black, glossy finish.
- **Assembly**
Tapped blind hole.



I.281

Revolving handles



- **Material**
Phenolic based (PF) Duroplast. Resistant to solvents, oils, greases and other chemical agents.
- **Colour**
Black, glossy finish.
- **Assembly**
Plain through hole.

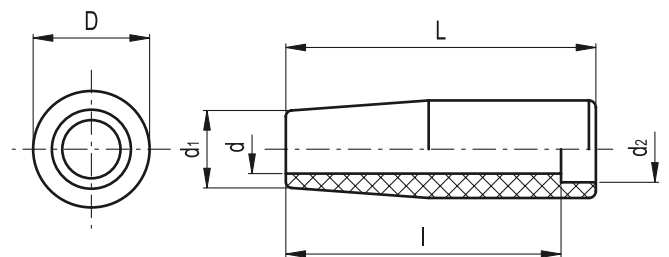

5
392

Fixed, revolving, fold-away handles

| Standard Elements | | Main dimensions | | | Mounting hole | | | △△ |
|-------------------|---------------|-----------------|----|----------------|---------------|----|----------------|----|
| Code | Description | L | D | d ₁ | d | l | l ₁ | g |
| 21501 | I.280/28-M5 | 28 | 14 | 11 | M5 | 12 | 1.5 | 5 |
| 21601 | I.280/40-M6 | 40 | 18 | 15 | M6 | 25 | 3.5 | 12 |
| 21602 | I.280/40-M8 | 40 | 18 | 15 | M8 | 25 | 3.5 | 12 |
| 21701 | I.280/50-M6 | 50 | 21 | 17 | M6 | 25 | 3.5 | 21 |
| 21702 | I.280/50-M8 | 50 | 21 | 17 | M8 | 35 | 7.5 | 20 |
| 21801 | I.280/65-M8 | 65 | 23 | 19 | M8 | 30 | 7.5 | 33 |
| 21802 | I.280/65-M10 | 65 | 23 | 19 | M10 | 40 | 7.5 | 30 |
| 21803 | I.280/65-M12 | 65 | 23 | 19 | M12 | 40 | 7.5 | 28 |
| 21901 | I.280/80-M10 | 80 | 26 | 21 | M10 | 55 | 7 | 47 |
| 21902 | I.280/80-M12 | 80 | 26 | 21 | M12 | 55 | 10 | 45 |
| 22001 | I.280/90-M10 | 90 | 28 | 22 | M10 | 55 | 7 | 64 |
| 22002 | I.280/90-M12 | 90 | 28 | 22 | M12 | 58 | 8 | 62 |
| 22101 | I.280/100-M12 | 102 | 31 | 25 | M12 | 58 | 8 | 90 |
| 22102 | I.280/100-M14 | 102 | 31 | 25 | M14 | 65 | 5 | 85 |
| 22201 | I.280/115-M12 | 116 | 29 | 23 | M12 | 58 | 8 | 88 |

| Standard Elements | | Main dimensions | | | Through hole | | | △△ |
|-------------------|-------------|-----------------|----|----------------|--------------|----------------|----|----|
| Code | Description | L | D | d ₁ | d | d ₂ | l | g |
| 22301 | I.281/40 | 39 | 18 | 15 | 8 | 12 | 35 | 10 |
| 22401 | I.281/50 | 50 | 21 | 17 | 10 | 14 | 43 | 16 |
| 22501 | I.281/65 | 64 | 23 | 19 | 12 | 16 | 56 | 22 |
| 22601 | I.281/80 | 79 | 26 | 21 | 13 | 17 | 70 | 37 |
| 22701 | I.281/90 | 89 | 28 | 22 | 14 | 19 | 79 | 49 |
| 22801 | I.281/100 | 100 | 31 | 25 | 16 | 20 | 89 | 66 |



elessa-GANTER

ELESA and GANTER models all rights reserved in accordance with the law. Always mention the source when reproducing our drawings.