

Handle



• Material

High resilience polypropylene based (PP) technopolymer, coated with "softtouch" thermoplastic elastomer (TPE) chemically bonded, hardness 90 Shore A. Resistant to solvents, oils, greases and other chemical agents.

• Colour

Black, matte finish.

• Assembly

Plain blind hole.

The elastic coupling by press-fit assembly on h9 tolerance drawn stock bars, is not affected by vibrations and prevents the handle from slipping off (see Technical Data on page A13).

Features and applications

The "softtouch" elastomer, improves the grip even in the presence of oils, greases and sweat from the hand. For this reason it is suitable for fitness machines, tools and machines for gardening and goods transport, high-precision instruments and disability aids.

Assembly instructions

Fit the handle onto slight chamfered shaft end and push as far as possible by hand or by means of a small press. Alternatively it is possible to tap the handle with a plastic or wooden mallet until firmly in place. In this case we strongly recommend to use a cloth or other suitable soft material over the product to avoid any surface damage.



Handle



• Material

Phenolic based (PF) Duroplast body, polyamide based (PA) technopolymer flange.

• Colour

Black, glossy finish.

• Assembly

Zinc-plated steel threaded stud, with chamfered flat end according to UNI 947 : ISO 4753 (see Technical Data on page A11).

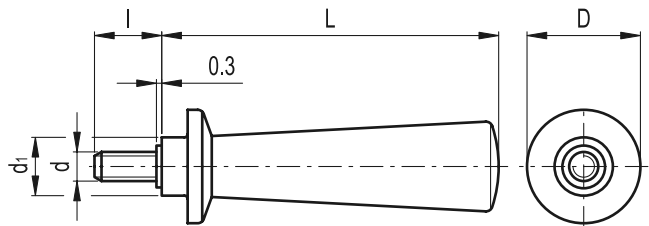
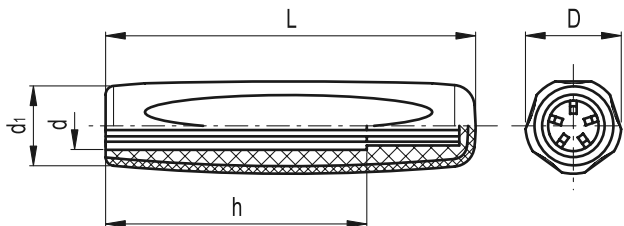

Standard Elements		Main dimensions			Mounting hole		△△
Code	Description	L	D	d1	d	h	g
286151-C1	EGH.85 N-8-C1-SOFT	85	22	18	8	60	30

Standard Elements		Main dimensions			Threaded stud		△△
Code	Description	L	D	d1	d 6g	l	g
20311	I.167/103 p-M8x25	104	35	18	M8	25	94