

GN 316

Ratchet spanners

- **Material**

Hardened steel wearing parts and black-oxide steel housing of the bore.

- **Handle**

Type I.222 N (see page 361) phenolic based (PF), Duroplast, black, glossy finish.

- **Standard executions available**

- Execution **K**: hole with keyway.
- Execution **M**: hole with threaded insert.
- Execution **V**: hole with DIN 79 square insert.

Features and applications

GN 316 ratchet spanners are used for assembly and repair work. They are however also practical for fixed applications on many machinery and equipment. They are well designed of robust construction and simple to use. The inserts are easily interchangeable and can be supplied individually.

Other executions available on request

- Execution **SK**: hole with hexagon.
- Different lengths.
- Different inserts.

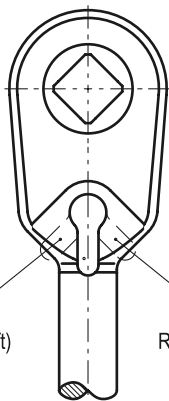

Reversing lever (left)

Reversing lever (right)

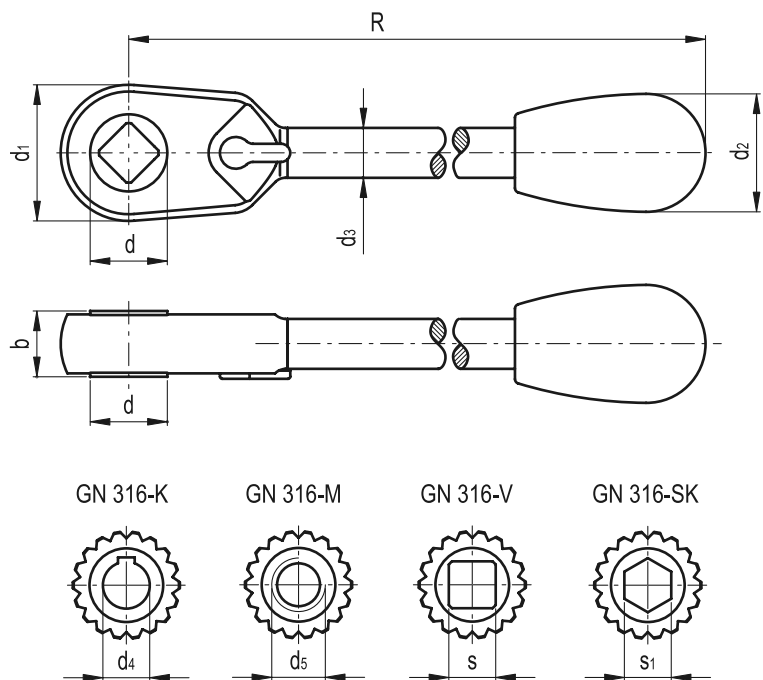

GN 316-K

GN 316-M

GN 316-V

GN 316-SK

Standard Elements	Main dimensions										Max. torque		⚖
	Description	d	d1	d2	d3	R	b	d4 H7	d5 6G	s	s1	[Nm]	
GN 316-12-M8	12	22	20	9	118	11	-	M8	-	-	-	40	-
GN 316-12-V8	12	22	20	9	118	11	-	-	8	-	-	40	-
GN 316-17-K10	17	30	25	11	156	14	10	-	-	-	-	100	-
GN 316-17-K12	17	30	25	11	156	14	12	-	-	-	-	100	-
GN 316-17-M10	17	30	25	11	156	14	-	M10	-	-	-	100	-
GN 316-17-M12	17	30	25	11	156	14	-	M12	-	-	-	100	-
GN 316-17-V10	17	30	25	11	156	14	-	-	10	-	-	100	-
GN 316-17-SK12*	17	30	25	11	156	14	-	-	-	12	-	100	-
GN 316-22-K14	22	39.5	33	14	187	17	14	-	-	-	-	130	-
GN 316-22-K16	22	39.5	33	14	187	17	16	-	-	-	-	130	-
GN 316-22-M14*	22	39.5	33	14	187	17	-	M14	-	-	-	130	-
GN 316-22-M16	22	39.5	33	14	187	17	-	M16	-	-	-	130	-
GN 316-22-V12	22	39.5	33	14	187	17	-	-	12	-	-	130	-
GN 316-22-V14	22	39.5	33	14	187	17	-	-	14	-	-	130	-
GN 316-22-SK14*	22	39.5	33	14	187	17	-	-	-	14	-	130	-
GN 316-26-K18	26	46	33	17	219	22	18	-	-	-	-	180	-
GN 316-26-M20	26	46	33	17	219	22	-	M20	-	-	-	180	-
GN 316-26-V17	26	46	33	17	219	22	-	-	17	-	-	180	-
GN 316-26-SK17*	26	46	33	17	219	22	-	-	-	17	-	180	-

* For sufficient quantities