

Knurled grip knobs

- **Material**
Turned black-oxide steel.
- **Assembly**
Tapped through hole.

Knurled grip knobs

- **Material**
AISI 303 stainless steel, sandblasted matte finish.
- **Assembly**
Tapped through hole.

Features and applications

AISI 303 stainless steel, thanks to its high resistance to corrosion, allows the application of these knobs on machines and equipment in those sectors where laws or particular hygienic, climatic and environmental factors make it mandatory to use corrosion resistant materials.

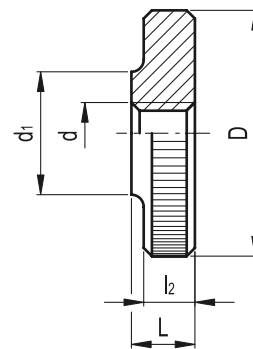
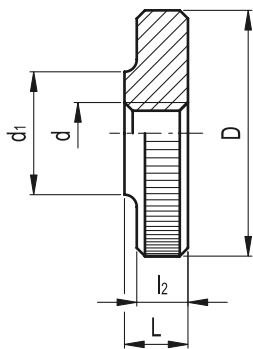

Standard Elements	Main dimensions				Mounting hole	⚖
Description	D	L	d ₁	l ₂	d	g
DIN 467-M3	12	3	6	2.5	M3	2
DIN 467-M4	16	4	8	3.5	M4	5
DIN 467-M5	20	5	10	4	M5	10
DIN 467-M6	24	6	12	5	M6	18
DIN 467-M8	30	8	16	6	M8	33
DIN 467-M10	36	10	20	8	M10	63
DIN 467-M12	40	12	22	10	M12	93

Standard Elements	Main dimensions				Mounting hole	⚖
Description	D	L	d ₁	l ₂	d	g
DIN 467-M3-NI	12	3	6	2.5	M3	2
DIN 467-M4-NI	16	4	8	3.5	M4	5
DIN 467-M5-NI	20	5	10	4	M5	10
DIN 467-M6-NI	24	6	12	5	M6	17
DIN 467-M8-NI	30	8	16	6	M8	35