

Adjustable lobe knobs (with push action)



- **Knob**

Glass-fibre reinforced polyamide based (PA) technopolymer. Resistant to solvents, oils, greases and other chemical agents. Built-in zinc alloy toothed insert for coupling to the metal clamping element.

- **Colour**

Black, matte finish.

- **Centre cap**

Black technopolymer centre cap. On request and for sufficient quantities, it can be supplied in other colours or with customised graphic symbols, marks or writings.

- **Clamping element**

AISI 303 stainless steel with toothed element for coupling to the built-in zinc alloy insert, stainless steel retaining screw and AISI 302 stainless steel return spring.

Features and applications

Particularly suitable for all those applications which require the knob to turn freely so as to avoid that clamping may be accidentally compromised.

Instructions

Press the knob to engage the toothing and turn it.

By releasing the knob the spring releases the toothing, thus the knob returns to the free position.

Ergonomy and design

The particular design of this knob follows rigorous ergonomic standards: five-lobe shape, blended radius, well proportioned rim height offer a natural, safe and comfortable grip, allowing the operator to obtain a strong clamping action.

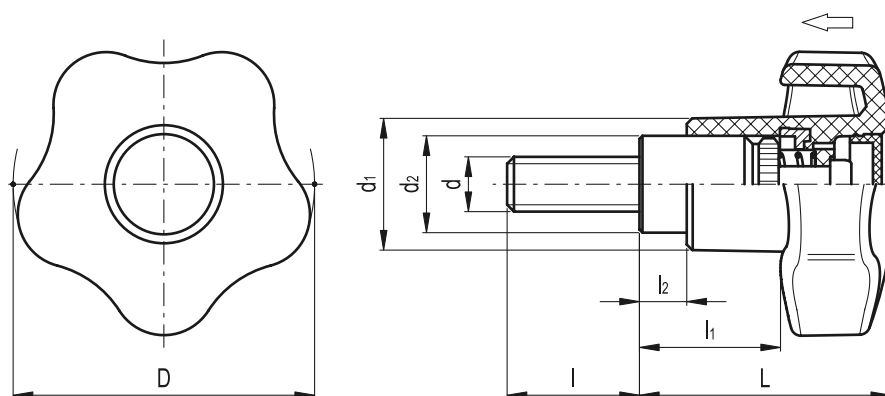

Standard Elements		Main dimensions						Thread		Teeth no.	\triangle
Code	Description	D	L	d ₁	d ₂	l ₁	l ₂	d	l	z	g
169771	VCTS-Z-40 SST-p-M6x20	40	37	18	13.5	22	7	M6	20	24	40
169772	VCTS-Z-40 SST-p-M6x25	40	37	18	13.5	22	7	M6	25	24	42
169773	VCTS-Z-40 SST-p-M6x32	40	37	18	13.5	22	7	M6	32	24	45
169774	VCTS-Z-40 SST-p-M6x40	40	37	18	13.5	22	7	M6	40	24	50
169781	VCTS-Z-40 SST-p-M8x20	40	37	18	13.5	22	7	M8	20	24	42
169782	VCTS-Z-40 SST-p-M8x25	40	37	18	13.5	22	7	M8	25	24	44
169783	VCTS-Z-40 SST-p-M8x32	40	37	18	13.5	22	7	M8	32	24	47
169784	VCTS-Z-40 SST-p-M8x40	40	37	18	13.5	22	7	M8	40	24	52
169792	VCTS-Z-50 SST-p-M8x25	50	42	22	16	23	8	M8	25	26	58
169793	VCTS-Z-50 SST-p-M8x32	50	42	22	16	23	8	M8	32	26	62
169794	VCTS-Z-50 SST-p-M8x40	50	42	22	16	23	8	M8	40	26	68
169795	VCTS-Z-50 SST-p-M8x50	50	42	22	16	23	8	M8	50	26	74
169802	VCTS-Z-50 SST-p-M10x25	50	42	22	16	23	8	M10	25	26	60
169803	VCTS-Z-50 SST-p-M10x32	50	42	22	16	23	8	M10	32	26	64
169804	VCTS-Z-50 SST-p-M10x40	50	42	22	16	23	8	M10	40	26	70
169805	VCTS-Z-50 SST-p-M10x50	50	42	22	16	23	8	M10	50	26	76