

Lobe knobs

- **Material**

AISI 304 stainless steel, sandblasted matte finish.

- **Assembly**

- Execution **C**: with butt-welded hub, H7 reamed blind hole.
- Execution **E**: with butt-welded hub, tapped blind hole.

For fixing GN 5334 on shafts by a grub screw see Technical Data on page A18.

Features and applications

AISI 304 stainless steel, thanks to its high resistance to corrosion, allows the application of these knobs on machines and equipment in those sectors where laws or particular hygienic, climatic and environmental factors make it mandatory to use corrosion resistant materials.



Lobe knobs

- **Material**

AISI 304 stainless steel, sandblasted matte finish.

- **Assembly**

AISI 304 stainless steel butt-welded hub with threaded stud.

Features and applications

AISI 304 stainless steel, thanks to its high resistance to corrosion, allows the application of these knobs on machines and equipment in those sectors where laws or particular hygienic, climatic and environmental factors make it mandatory to use corrosion resistant materials.

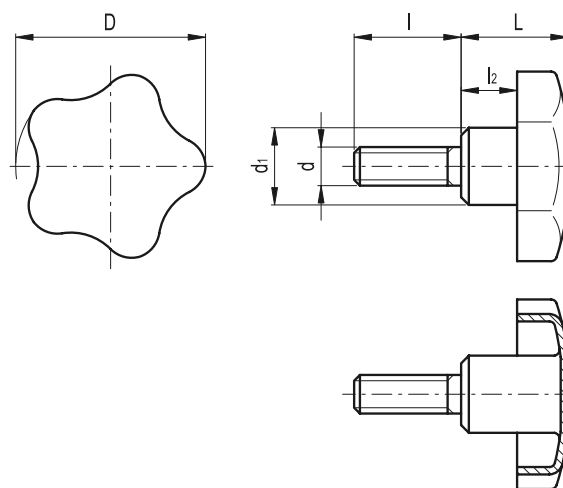
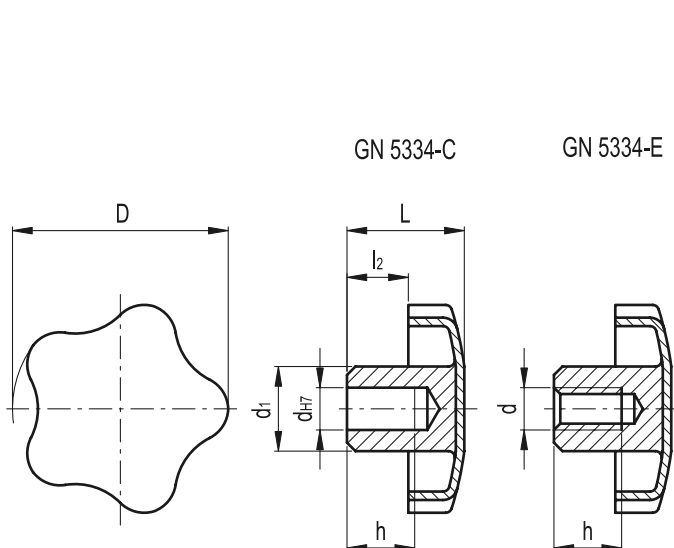

Standard Elements	Main dimensions				Mounting hole			△△
Description	D	L	d ₁	l ₂	d H7	d	h	g
GN 5334-40-B8-C	40	24	14	12	8	-	15	36
GN 5334-40-M8-E	40	24	14	12	-	M8	15	37
GN 5334-50-B10-C	50	30	18	16.5	10	-	18	63
GN 5334-50-M10-E	50	30	18	16.5	-	M10	18	65
GN 5334-60-B12-C	60	37.5	20	20	12	-	22	105
GN 5334-60-M12-E	60	37.5	20	20	-	M12	22	107

Standard Elements	Main dimensions				Threaded pin		△△
Description	D	L	d ₁	l ₂	d	l	g
GN 5334-40-M8-20	40	24	14	12	M8	20	50
GN 5334-40-M8-30	40	24	14	12	M8	30	55
GN 5334-40-M8-40	40	24	14	12	M8	40	56
GN 5334-50-M10-20	50	30	18	16.5	M10	20	95
GN 5334-50-M10-30	50	30	18	16.5	M10	30	97
GN 5334-50-M10-40	50	30	18	16.5	M10	40	100
GN 5334-60-M12-30	60	37.5	20	20	M12	30	155
GN 5334-60-M12-40	60	37.5	20	20	M12	40	162
GN 5334-60-M12-50	60	37.5	20	20	M12	50	169