

DIN 6336

Lobe knobs

Material

Nodular cast iron.

Assembly

- Execution **B**: hub, H7 reamed through hole.
- Execution **C**: hub, H7 reamed blind hole.
- Execution **D**: hub, tapped through hole.
- Execution **E**: hub, tapped blind hole.

Special execution on request (For sufficient quantities)

- Hub not drilled (execution A).

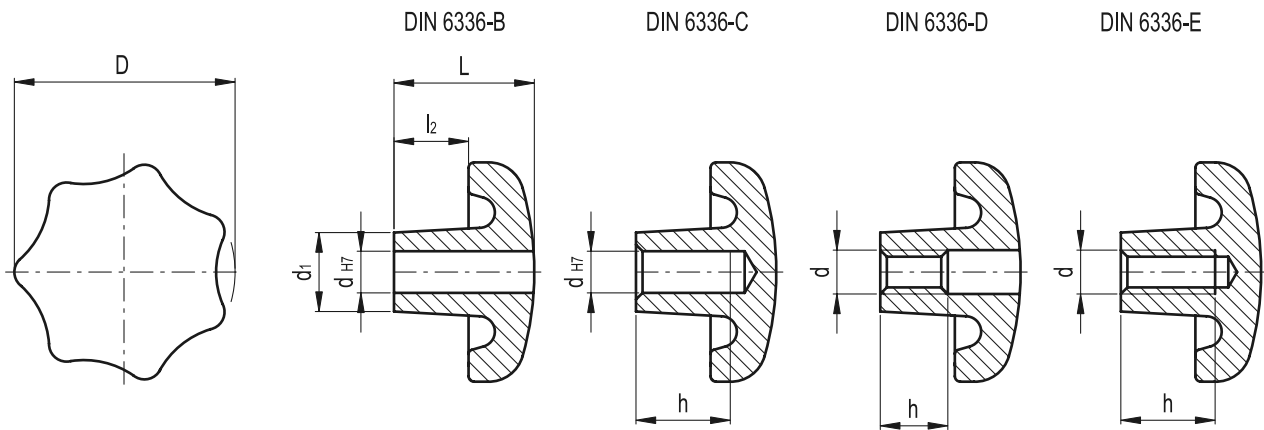

Standard Elements	Main dimensions				Mounting hole			△/△
Description	D	L	d ₁	l ₂	d _{H7}	d	h	g
DIN 6336-GG-32-B6-B	32	20	12	10	6	-	-	46
DIN 6336-GG-32-B6-C	32	20	12	10	6	-	12	47
DIN 6336-GG-32-M6-D	32	20	12	10	-	M6	10	46
DIN 6336-GG-32-M6-E	32	20	12	10	-	M6	12	49
DIN 6336-GG-40-B8-B	40	25	14	13	8	-	-	69
DIN 6336-GG-40-B8-C	40	25	14	13	8	-	15	70
DIN 6336-GG-40-M8-D	40	25	14	13	-	M8	13	69
DIN 6336-GG-40-M8-E	40	25	14	13	-	M8	15	70
DIN 6336-GG-50-B8-B	50	32	18	17	8	-	-	106
DIN 6336-GG-50-B8-C	50	32	18	17	8	-	18	108
DIN 6336-GG-50-M8-D	50	32	18	17	-	M8	16	103
DIN 6336-GG-50-M8-E	50	32	18	17	-	M8	18	111
DIN 6336-GG-50-B10-B	50	32	18	17	10	-	-	143
DIN 6336-GG-50-B10-C	50	32	18	17	10	-	18	145
DIN 6336-GG-50-M10-D	50	32	18	17	-	M10	16	140
DIN 6336-GG-50-M10-E	50	32	18	17	-	M10	18	148
DIN 6336-GG-63-B10-B	63	40	20	21	10	-	-	192
DIN 6336-GG-63-B10-C	63	40	20	21	10	-	22	196
DIN 6336-GG-63-M10-D	63	40	20	21	-	M10	20	187
DIN 6336-GG-63-M10-E	63	40	20	21	-	M10	22	204
DIN 6336-GG-63-B12-B	63	40	20	21	12	-	-	242
DIN 6336-GG-63-B12-C	63	40	20	21	12	-	22	246
DIN 6336-GG-63-M12-D	63	40	20	21	-	M12	20	237
DIN 6336-GG-63-M12-E	63	40	20	21	-	M12	22	254
DIN 6336-GG-80-B12-B	80	50	25	25	12	-	-	478
DIN 6336-GG-80-B12-C	80	50	25	25	12	-	28	482
DIN 6336-GG-80-M12-D	80	50	25	25	-	M12	20	473
DIN 6336-GG-80-M12-E	80	50	25	25	-	M12	28	482
DIN 6336-GG-80-B16-B	80	50	25	25	16	-	-	538
DIN 6336-GG-80-B16-C	80	50	25	25	16	-	28	542
DIN 6336-GG-80-M16-D	80	50	25	25	-	M16	20	533
DIN 6336-GG-80-M16-E	80	50	25	25	-	M16	28	460

DIN 6336



Lobe knobs

- **Material**
 - **cast aluminium** with matte finish (type MT)
 - **cast aluminium** with deburred and mirror polished finish (type PL).
- **Assembly**
 - Execution **C**: hub, H7 reamed blind hole.
 - Execution **D**: hub, tapped through hole.
 - Execution **E**: hub, tapped blind hole.

Special execution on request (For sufficient quantities)
- Hub not drilled (execution A).

2

151

Clamping knobs

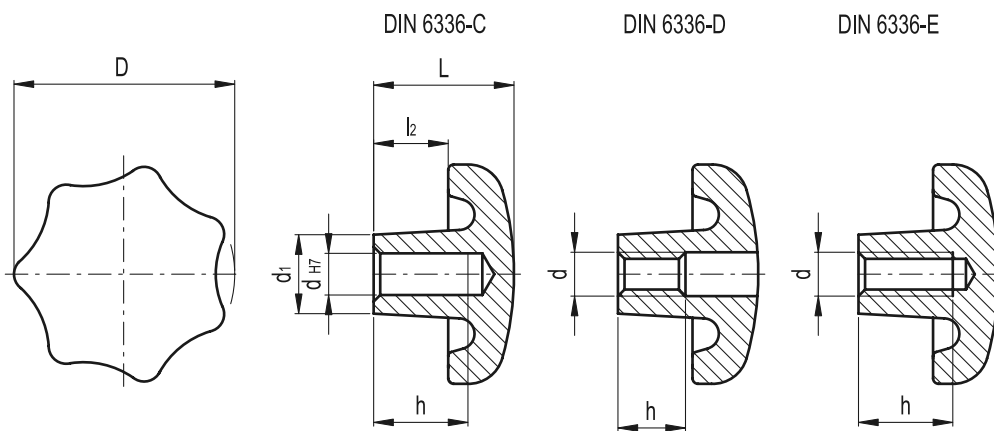

Standard Elements	Main dimensions				Mounting hole			\triangle/∇
Description	D	L	d ₁	l ₂	d H7	d 6H	h	g
DIN 6336-AL-40-B8-C*	40	25	14	13	8	-	15	25
DIN 6336-AL-40-M8-D*	40	25	14	13	-	M8	13	25
DIN 6336-AL-40-M8-E*	40	25	14	13	-	M8	15	25
DIN 6336-AL-50-B10-C*	50	32	18	17	10	-	18	50
DIN 6336-AL-50-M10-D*	50	32	18	17	-	M10	16	45
DIN 6336-AL-50-M10-E*	50	32	18	17	-	M10	18	50
DIN 6336-AL-63-B12-C*	63	40	20	21	12	-	22	85
DIN 6336-AL-63-M12-D*	63	40	20	21	-	M12	20	85
DIN 6336-AL-63-M12-E*	63	40	20	21	-	M12	22	85
DIN 6336-AL-80-B16-C*	80	50	25	25	16	-	28	180
DIN 6336-AL-80-M16-D*	80	50	25	25	-	M16	20	220
DIN 6336-AL-80-M16-E*	80	50	25	25	-	M16	28	196

*Complete the description of the standard item needed by adding the index of the finish: MT (matte) or PL (polished).