

GN 227



Pressed steel spoked handwheels

- **Material**
Pressed steel, epoxy resin coating.
- **Colour**
RAL 9005 black (type SW), RAL 3000 red (type RT), uncoated (type RH).
- **Assembly**
Reinforced hub with square hole.

Features and applications

GN 227 pressed steel spoked handwheels consist of a single unwelded piece of pressed sheet metal manufactured by a special process to give a reinforced hub. They have been especially designed for valves and are very resistant to high temperature and fire.

The slightly tapered hole allows easy installation and firm seating on a spindle.

For smaller diameters see VCRT. (see page 160) technopolymer lobe knobs.

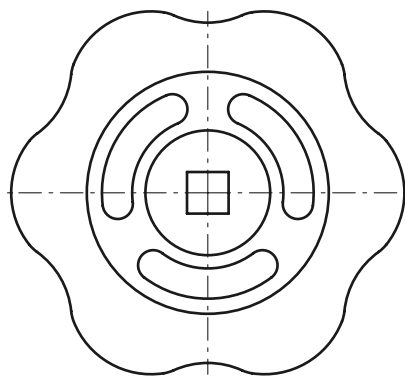
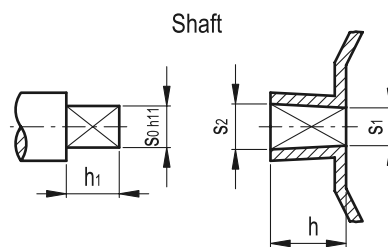
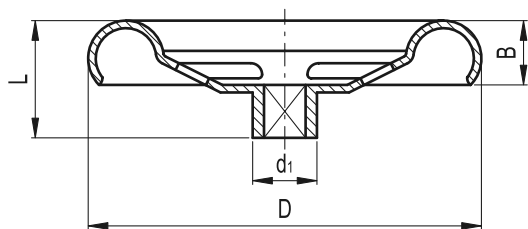

Standard Elements	Main dimensions				Bore					Spokes no.	△ g
	D	L	B	d1	s0	s1 -0.1	s2 -0.1	h ±0.5	h1 -1		
GN 227-50-V6-*	50	15.5	8	10	V6	5.8	6.15	9	8	3	21
GN 227-50-V7-*	50	15.5	8	10	V7	6.8	7.15	9	8	3	20
GN 227-60-V6-*	60	16.5	10	10	V6	5.8	6.15	9	8	3	30
GN 227-60-V7-*	60	17.5	10	10	V7	6.8	7.15	10	9	3	29
GN 227-70-V7-*	70	19	11	11	V7	6.8	7.15	10	9	3	38
GN 227-70-V8-*	70	19	11	11	V8	7.8	8.15	10	9	3	37
GN 227-80-V8-*	80	20	12	14	V8	7.8	8.15	11	10	3	63
GN 227-80-V9-*	80	20	12	14	V9	9	9.15	12	11	3	62
GN 227-90-V9-*	90	24	14	14	V9	8.8	9.15	12	11	3	80
GN 227-100-V9-*	100	24	18	15	V9	9	9.2	13	12	4	103
GN 227-100-V10-*	100	24	18	15	V10	9.8	10.2	13	12	4	102
GN 227-120-V11-*	120	31	16	17	V11	11	11.2	14	13	4	165
GN 227-120-V12-*	120	32.5	16	17	V12	12	12.25	16	14	4	164
GN 227-140-V12-*	140	32.5	19	17	V12	12	12.25	16	14	4	237
GN 227-160-V14-*	160	37	21	19	V14	14	14.25	20	18	4	310

*Complete the description of the standard item needed by adding the index of the colour of the handwheel: SW (black), RT (red) or RH (uncoated).